



passion
for coffee

GB User manual



WELCOME TO THE NIVONA FAMILY!

We are delighted at the confidence you have shown in us by choosing a quality product from NIVONA.

We would like to express our sincere **THANKS**.

To ensure maximum enjoyment of your NIVONA machine, please read through this document carefully and pay attention to the safety instructions before using the machine for the first time.

Please keep this document in a safe place. Then you can use it as a reference or pass it on to any subsequent owner.

We hope you enjoy your NIVONA product and, with it, a good, flavourful cup of coffee.

Best wishes to you from the NIVONA team!



SYMBOLS USED

The following symbols are used in these instructions:



CAUTION

This symbol draws your attention to possible dangers.



NOTE

This symbol draws your attention to special information.



TIP

This symbol indicates helpful advice on how to use the machine.

TABLE OF CONTENTS

1. SAFETY INFORMATION	4	7. BASIC SETTINGS.....	15
1.1. Correct use	4	7.1. General settings	15
1.2. General instructions for the user	4	7.2. Set grind fineness	16
1.3. Limits to the range of users	5	7.3. Aroma Balance System	16
2. CONTROL ELEMENTS.....	6	7.4. NIVONA App	17
3. OPERATION OF THE MACHINE	7	7.5. Flying Picture	17
3.1. Function switches	7	8. CLEANING & MAINTENANCE	18
3.2. Operation with the rotary dial.....	7	8.1. Rinse frother	18
3.3. Functions of the buttons.....	8	8.2. Clean frother.....	19
4. INITIAL STARTUP	8	8.3. Rinse system	20
4.1. Preparation	8	8.4. Clean system	20
4.2. Initial Start menu.....	9	8.5. Descale system.....	21
5. MENU NAVIGATION.....	11	8.6. Remove & clean brewing unit.....	22
6. PREPARE SPECIALITY COFFEES	11	8.7. Clean regularly by hand.....	22
6.1. Draw speciality coffee.....	11	8.8. Disassemble and clean frother.....	23
6.2. Recipe menu	12	8.9. Change filter	24
6.3. 2-cup function.....	13	8.10. Status of Maintenance.....	24
6.4. Cappuccino-Connaisseur.....	13	9. SOLVING PROBLEMS YOURSELF	25
6.5. Flavour profiles.....	13	10. ACCESSORIES & COFFEE ASSORTMENT	28
6.6. AROMA PRE-select	13	11. CUSTOMER SERVICE & WARRANTY	28
6.7. My Coffee (for individual speciality coffees).....	13	12. PACKAGING & DISPOSAL	28
6.8. Prepare ground coffee	14	13. TECHNICAL DATA.....	29

1. SAFETY INSTRUCTIONS

CAUTION

Repairs to electrical appliances must be carried out only by specialised technicians! Improper repairs can expose the user to considerable dangers! If the machine is used other than for its intended purpose or is operated or maintained improperly, we cannot accept liability for any resulting damage!

CAUTION

Actuating the on/off switch during the brewing process can damage the machine! Switch the machine off only when it is idle!

CAUTION

Danger of burns! Hot water might spray out of the outlet at first when steam or hot water is drawn. Touch the outlet only when cold.

1.1. Correct use

- The machine may only be used for its designated purpose (use only in private households) and is not intended for commercial use, which would void the warranty (see accompanying warranty terms).

1.2. General instructions for the user

- Set the machine on a dry, level and stable surface, and use it only indoors. Never place this machine on a hot surface, near other appliances which become very hot when in use (e.g. stove, deep fryer), or near open flames.
- The machine must not be used in cupboards or other closed pieces of furniture.
- The mains supply voltage must always match the working voltage of the machine. Please refer to the type plate on the machine.
- The machine must not be used at altitudes over 2000 m above sea level.
- Do not operate the machine if the mains supply cable or the casing is damaged. Never let the mains supply cable touch hot parts.
- If the mains supply cable of the machine is damaged, it must be replaced by the manufacturer, its customer service representative, or a similarly qualified technician to avoid hazards.
- Never immerse the machine in water.
- Always keep the mains supply plug dry and keep it away from moisture
- Do not pull on the mains supply cable to disconnect the plug from the mains socket.

- If a fault occurs, disconnect the mains plug immediately (never by pulling on the mains supply cable or the machine itself).
- Before carrying out maintenance or cleaning, check that the machine is switched off and that the mains plug is disconnected.
- No liability for damage is accepted in case of incorrect operation, improper use, or incorrect repairs. The warranty is void in these cases.
- Always follow the instructions for cleaning and descaling! Failure to comply voids the warranty.
- Never clean the machine or individual parts in the dishwasher. Failure to comply voids the warranty.
- Do not leave the machine switched on unnecessarily.
- If you will be away for several days, always unplug the mains cable.
- Please use the integrated coffee grinder only to grind roasted and untreated coffee beans, not for other food items! Always make sure that there are no foreign objects mixed in with the coffee beans, which voids the warranty.

- If repair of the machine is required (including replacement of the mains cable!), please first contact the NIVONA service telephone or the dealer from which the machine was purchased, and, after consultation with us and observing the section “How to make your machine ready for shipment” in Chapter 11 of this document, send it to **NIVONA Central Customer Service, Südwestpark 49, D-90449 Nuremberg, Germany.**

1.3. Limits to the range of users

- This machine can be used by children 8 and older and by persons with physical, sensory, or mental impairments or who are lacking in experience and knowledge, provided they are acting under supervision or have been instructed on how to use the machine safely and are aware of the possible dangers. Children must not play with the machine. Cleaning and maintenance of this machine must not be carried out by children unless they are age 8 or over and are acting under supervision. The machine and its connection line must be kept away from children younger than 8.

DE

GB

FR

NL

PL

RU

2.

2. CONTROL ELEMENTS

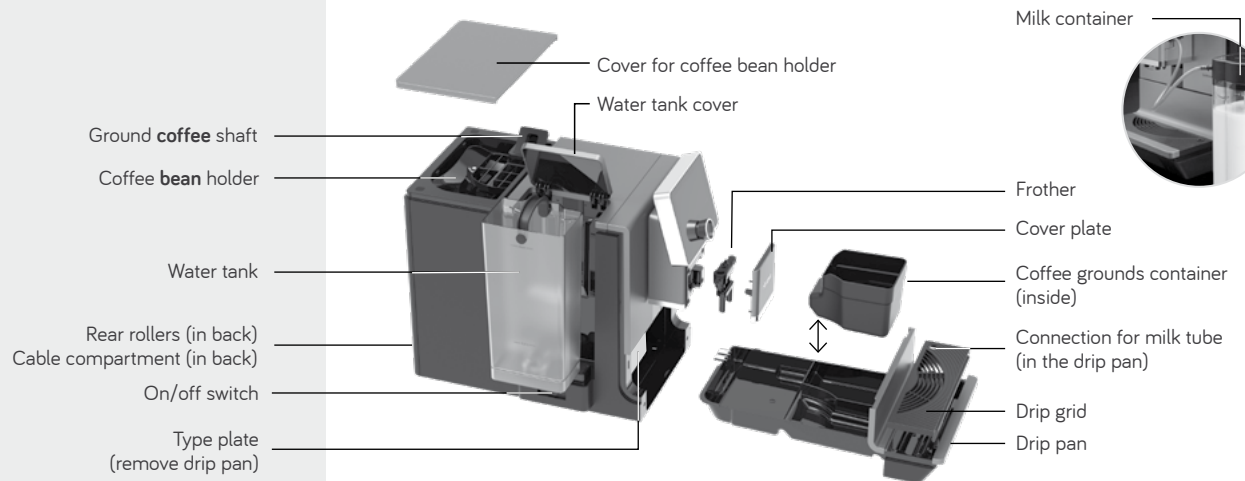

WELCOME PACK (included with machine)

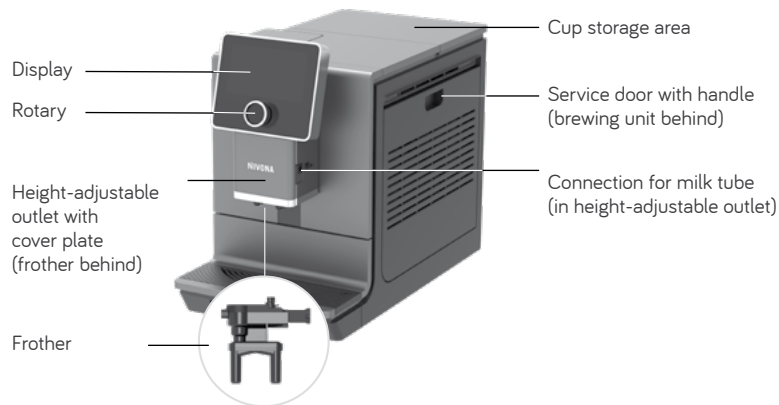

3. OPERATION OF THE MACHINE

3.1. Function switches

The NIVONA machine can be operated using the *rotary dial* and the touchscreen.



Rotary dial
navigate / select /
change / confirm
by turning and pressing



Touchscreen
navigate / select /
change / confirm
by touching

3.2. Operation with the rotary dial | Touchscreen

Turning the rotary dial

To select / navigate between and within the main menus **BEVERAGES** (speciality coffees), **SETTINGS** and **MAINTENANCE** and to change the setting options in the submenus and recipe menu.

Short press | Short touch

To start / confirm the currently marked / selected function and to switch between the three main menus **BEVERAGES** (speciality coffees), **SETTINGS** and **MAINTENANCE**.

In the recipe menu, the first short press / touch selects the setting parameters.

The parameter can be changed by turning the *rotary dial* or by another *short touch* on the parameter. Another *short press* confirms the change.

A parameter changed by a *short touch* does not have to be confirmed.

The quantity of beverages can only be changed by turning the *rotary dial*.

A short press when the beverage is drawn cancels the procedure. If the draw is cancelled while the parameters are still optically marked, the *rotary dial* must be pressed 2x.

Long press | Long touch

In the **BEVERAGES** (speciality coffees) menu, a long press / touch switches to the recipe menu to change the settings here.



Turning



Pressing



Touching

3.3. Functions of the buttons

The switches can be selected either by touching (directly) or with the *rotary dial* (by turning and pressing). To change a setting option in the **BEVERAGES** (speciality coffees) and **SETTINGS** menus, turn the *rotary dial*.

START	start	CANCEL	cancel
SAVE	save	DELETE	delete My Coffee recipe
NEXT	confirm to next step	EDIT NAME	change the name of a My Coffee recipe
	one step back	The currently selected symbol / function is optically marked	

Even **during** a coffee draw that has already started, various parameters can be changed by turning the *dial* as long as they are **optically marked**.

A beverage draw can be cancelled with **CANCEL**. If the draw is cancelled with the *rotary dial* while the parameters are still optically marked, it must be pressed 2x.

4. INITIAL STARTUP

4.1. Preparation

- Remove the machine and other supplied parts from the packaging.
- Place the machine on a level, dry work surface (ventilation slots must not be covered).

- Connect the mains supply cable to a power socket which has been correctly installed (any unnecessary length of cable remains inside the cable compartment)
- Connect milk tube to the height-adjustable outlet and drip pan
- Switch on machine

When the machine is switched on **after the initial startup**, it first heats up. If the automatic switch-on rinse is activated, the display shows **SYSTEM RINSES** and the rinse procedure starts automatically. If the automatic switch-on rinse is deactivated, the display shows **Please rinse system** and the rinse procedure must be started manually by confirming.

4.2. Initial Start menu

The instructions on the display lead you through the Initial Start menu conveniently and step-by-step.

Set language

- Select the language with the *rotary dial* and confirm

Set filter

- Select filter setting with the *rotary dial*

Operation with filter

- Set the menu to **Yes**
- Using the mounting aid at the end of the measuring spoon, screw the filter into the water tank and confirm using the *rotary dial*.

NOTE

If used with a filter, the machine does not need to be descaled as often.

Operation without filter (factory setting)

- Set the menu to **No** and confirm with the *rotary dial*

When using the machine without a filter, the water hardness must be entered in the next step.



Milk tube – connect-
ed to drip pan

NOTE

Details on **Operation of the Machine** are contained in Chapter 3, starting at page 7.



SCAN ME!

CAUTION

Insert the filter **straight** and do not overturn!

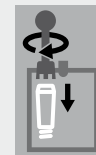

Screw filter
into the
water tank

Test strips	Degree of hardness	Display
≤ 1 red point	0 - 9°	Water hardness 1
2 red points	10 - 14°	Water hardness 2
3 red points	15 - 19°	Water hardness 3 (factory setting)
≥ 4 red points	≥ 20°	Water hardness 4

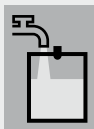

Fill water tank

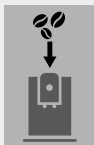

Fill coffee beans

NOTE

At initial startup, the grind chamber is still empty. After the first grinding, it is possible that **Please fill coffee beans** is displayed and the machine does not make coffee.

➤ Press the *rotary dial* again for an additional draw; the process is then repeated

SYSTEM
FILLS/RINSESFILTER
RINSES

Set water hardness*

- Immerse supplied test strip briefly in water, shake it off and read the test result after about 1 minute
- In the menu, use the *rotary dial* to select the water hardness read from the test strip and confirm

Fill water tank (> 0.5l)

- **Remove** the water tank, fill water tank with fresh, cold water without carbonation (no mineral water), reinsert the tank, and confirm using the *rotary dial*

Do not fill with any carbonated liquids or any other liquids, or the warranty is void!

Fill coffee bean holder

- Fill the coffee bean holder with untreated, roasted coffee beans without foreign objects or dirt and without sugar, then close the flavour protection cover well and confirm using the *rotary dial*

Fill / rinse system, rinse filter

- Place a large container (> 0.5 l) under the outlet and confirm with the *rotary dial*
- Wait until no more water comes out of the outlet, then empty the container

Operating note

At the end of the initial startup, a note appears for the beverage draw.

- Confirm note as well as the next instruction with the *rotary dial* / by touching

All settings that were determined during initial startup can be changed at any time in the **SETTINGS** menu.

* For operation without filter

5. MENU NAVIGATION

In the NIVONA machine, you can select the main menus **SETTINGS**, **BEVERAGES** (speciality coffees), and **MAINTENANCE**. All available functions of the machine can be carried out within these main menus.

Detailed information on navigation within and between the main menus is found in Chapter 3 starting at page 7.

6. PREPARE SPECIALITY COFFEES

6.1. Draw speciality coffee

- Select the desired speciality coffee in the **BEVERAGES** (speciality coffees) menu
- For speciality coffees with milk, connect the milk-filled container (milk container, milk refrigerator, Tetra Pack, or similar) to the lower end of the milk tube. The upper end remains in the outlet
- A short press / touch on the desired speciality coffee begins the beverage draw
- After completion of the draw of a speciality coffee with milk, the display shows the message / instruction to rinse the frother. The frother should then be rinsed as soon as possible, but at the latest before switching off the machine. To do this, reconnect the tube to the drip pan, and select and confirm the message / instruction on the display. Follow the instructions in the display up to the end of the program.



SETTINGS

BEVERAGES
(speciality
coffees)

MAINTENANCE

BEVERAGES
(speciality
coffees)

Connect milk source

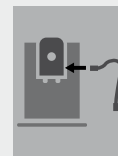
Connect tube
to the outlet ......and put in
drip plate

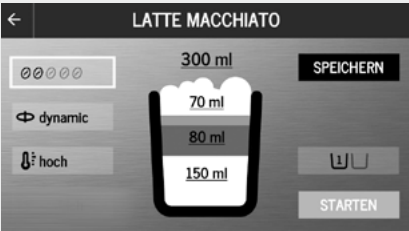

Recipe menu

6.2. Recipe menu

The recipe menu is a submenu in the individual speciality coffees. Here, the factory recipe settings can be changed individually and stored permanently.

- A long press / touch on the symbol of a speciality coffee leads to the **recipe menu** of the beverage

Adjustable parameters in the recipe menu:

	Coffee strength		Flavour profiles (dynamic, constant, intense)	80 ml — 80 ml — 40 ml	Quantity (coffee / milk foam / water / milk, depending on the speciality coffee)
	Temperature		1- or 2-cup- function		

- A short press / touch on the (activated) **SAVE** switch saves the beverage recipe with the changed parameters.
- A short press / touch on the (activated) **START** switch begins the beverage draw with the changed parameters.

6.3. 2-cup function*

To fill two cups directly next to each other from the same beverage draw, a second cup must be placed under the outlet and then either

- Press the *rotary dial* briefly twice in succession to start beverage preparation (for the current draw) or
- Change the cup symbol in the recipe menu of the speciality coffee

6.4. Cappuccino-Connaisseur

By changing the sequence in the sequence symbol, cappuccino / caffè latte enthusiasts can specify **in the recipe menu** whether the milk or the coffee goes into the cup first.

6.5. Flavour profiles

Changing the flavour profile (dynamic | constant | intense) **in the recipe menu** changes the brewing process and extraction from the beans and thus the taste of the coffee (see also Chapter 7.3. Aroma Balance System on page 16).

6.6. AROMA PRE-select

With the NIVONA App, all coffee recipes that have been perfectly matched to the respective NIVONA coffee type can be transferred to the NIVONA machine via an activated Bluetooth connection (see chapter 7.4.).

- Start **AROMA PRE-select** in the NIVONA App and select the NIVONA coffee type used.



1 Cup



2 Cups



1st milk



1st coffee



dynamic



constant



intense



AROMA PRE-select



TIP

The NIVONA coffee types are available from our authorised NIVONA retailers.

* not for CAFFÈ AMERICANO, HOT WATER, MY COFFEE, ground coffee

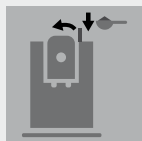
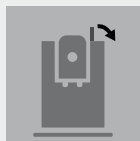

My Coffee

Fill Coffee
powderClose powder
shaft**CAUTION**

The ground coffee shaft is not a storage container. Therefore, never add more than one portion to the shaft and use only fresh or vacuum-packed ground coffee from coffee beans.

Water-soluble instant coffee must not be used!

**NOTE**

If you accidentally open the ground coffee shaft – or have not started a beverage draw after adding ground coffee – the machine is automatically rinsed about one minute after the cover is closed again and is then ready for use again.

6.7. My Coffee (for individual speciality coffees)

Up to 9 different beverages can be individually set, named and stored with the NIVONA machine.

- To do this, in the **BEVERAGES** (speciality coffees) menu select the menu option **MY COFFEE**
- Select a memory location with a long press / touch
- Select a base recipe (speciality coffee), assign a name (if necessary, delete the MY COFFEE presetting and save the name with **OK**), set the recipe individually and save it
- A stored **My Coffee recipe** can be changed or edited with a long press of the *rotary dial* on the corresponding symbol and also removed through confirmation of deletion

6.8. Prepare ground coffee

- Open the cover of the ground coffee shaft (underneath the cover on the upper right of the machine)
- The display shows **Fill Coffee powder** and **Close powder shaft**
- Add a level measuring spoon of ground coffee
- Close cover and flap
- The display shows when the ground coffee is ready
- Place a cup in the middle below the coffee outlet
- Select the beverage
- Start preparation











SETTINGS

7. BASIC SETTINGS

7.1. General settings

All of the following parameters can be changed, edited or checked in the **SETTINGS** menu using the *rotary dial*.

 Live Programming <ul style="list-style-type: none"> – Change and save the recipe setting while a beverage is being drawn (choose a speciality coffee and follow the instructions on the display) 	 Times <ul style="list-style-type: none"> – Activate / deactivate automatic switch-on time (setting of the current time as well as the switch-on time) – Activate / deactivate automatic switch-off time* – Set time of day** (Only appears if the switch-on time is activated in the menu Activate / deactivate automatic switch-on time) 	 Comfort Settings <ul style="list-style-type: none"> – Set water tank lighting – Activate / deactivate energy-saving (ECO) mode*** – Set display brightness – Activate / deactivate automatic display lock – Activate / deactivate automatic switch-on rinse – Activate / deactivate automatic switch-off rinse
 Filter <ul style="list-style-type: none"> – Set operation with / without filter 	 Water hardness <ul style="list-style-type: none"> – Set the water hardness (Only displayed during operation without filter) 	 Language <ul style="list-style-type: none"> – Set the language
 Statistics <ul style="list-style-type: none"> – Displays the draws per speciality coffee and the performed maintenance functions since initial startup 	 Factory setting <ul style="list-style-type: none"> – Recipes, settings and Bluetooth can be reset to the factory settings here 	 Bluetooth <ul style="list-style-type: none"> – Connection to smartphone / tablet and control of the machine with the NIVONA App

* CAUTION

Extending the time before switch-off increases energy consumption. Detailed information on energy consumption can be found via the QR code in chapter 13 on p. 29.

** After disconnection from the power network, the time of the day must be reset

*** If the *rotary dial* has not been actuated for a longer period of time, the machine switches automatically into the **ECO mode**. A screen saver appears on the display. Actuate the *rotary dial* to leave the **ECO mode**.

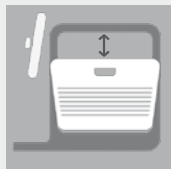

Open/close
service door

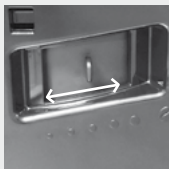

Set grind fineness

⚠ CAUTION

The grind fineness may only be set when the grinder is running!

The grinder can be adjusted to adapt to the roast of the coffee beans. We recommend always leaving the grinder at a medium setting.

i NOTE

When changing the grind fineness, we recommend:

- a finer setting for light roasts (regulator further to the left),
- a coarser setting for dark roasts (regulator further to the right).

7.2. Set grind fineness

To change the grind fineness, please:

- Open the service door on the right side of the housing (gently pull the unlocking device inside the handle upward, then carefully remove the service door from the housing)
- Place cup under the height-adjustable outlet
- Set *rotary dial* in the **BEVERAGES** (speciality coffees) menu to **Espresso**, then press the *rotary dial*.
- While the grinder grinds, change the grind fineness by moving the regulator (above right) (left = finer, right = coarser)
- Close service door again (guide pins on the bottom of the service door into the recesses, then press the service door until it locks in place)

7.3. Aroma Balance System

The NIVONA machine is equipped with the **Aroma Balance System**, which brings out the best of the bean for every taste. The three flavour profiles **dynamic**, **constant** and **intense** create a different taste with the same bean, same coffee strength, and same water amount.



dynamic



constant



intense

7.4. NIVONA App

The NIVONA machine can be controlled and operated through the NIVONA App as it is equipped with a Bluetooth interface.

- Download the NIVONA App from the Google Play Store (Android) or from the Apple App Store (iOS) onto your mobile device
- In the **SETTINGS** menu, select the **Bluetooth** menu option and activate Bluetooth with **Connect** on the NIVONA machine
- Activate Bluetooth on your mobile device and from there connect to the NIVONA machine through the NIVONA App

Now the NIVONA machine can be operated / controlled through the app.

7.5 Flying Picture

A personalised display lock can be startup as a setting on the NIVONA machine using the NIVONA App. An activated Bluetooth connection can be used to transfer a picture from the mobile end device (smartphone, tablet) to the NIVONA machine's display (Flying Picture) which is then displayed as a personal display lock (see also Chapter 7.4).



Bluetooth



Flying Picture

8. CLEANING & MAINTENANCE

All cleaning and maintenance programs can generally be selected and started in the **MAINTENANCE** menu. If a message / instruction for a cleaning / maintenance activity appears on the display, this program can also be started directly through the message / instruction.

- Select and confirm the instruction with the *rotary dial* or
- Select **MAINTENANCE** menu.
- Select the cleaning or maintenance program and start it with the *rotary dial* / by touching

The machine starts the corresponding cleaning or maintenance process and displays instructions for additional actions.

- Follow the instructions in the display up to the end of the program and confirm each time with the *rotary dial* / by touching

8.1. Rinse frother

After you make speciality coffees with milk, the display instructs you to rinse the frother. This should be done as soon as possible, but at the latest before switching off the machine. Proceed as follows:

- Select and confirm the instruction with the *rotary dial* or
- In the **MAINTENANCE** menu, select the menu option **Rinse frother**



MAINTENANCE



CAUTION

The running program must not be interrupted!



Rinse frother

- Connect the supplied tube with one end to the height-adjustable outlet and put the other end in the drip pan, and confirm with the *rotary dial*
- Place a sufficiently large container (≥ 0.5 l) under the height-adjustable outlet and confirm with the *rotary dial* / by touching

The machine starts the rinse process. As soon as the rinse cycle is ended, the machine heats up and is then ready for operation again.

8.2. Clean frother

- Select and confirm the message / instruction with the *rotary dial* / by touching or
- In the **MAINTENANCE** menu, select the menu option **Clean frother**
- Put some detergent (recommendation: NIVONA CreamClean milk system cleaner) and water in a container (at least 0.3 l)
- Please observe the instructions of the detergent manufacturer for the mix ratio
- Follow the instructions in the display up to the end of the program and confirm each time with the *rotary dial* / by touching

The machine then heats up and is ready for operation again.

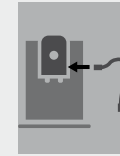

Connect tube to the outlet ...



...and put in drip plate



CAUTION

The running program must not be interrupted!



NOTE

A message / instruction is shown on the display when the frother has to be cleaned.



Clean frother



SCAN ME!

**CAUTION**

The running program must not be interrupted!



Rinse system

**CAUTION**

The running program must not be interrupted!

Please do not insert a cleaning tablet into the round opening of the brewing unit until the machine instructs you to do this.



Clean system



SCAN ME!

8.3. Rinse system

The system should be rinsed from time to time.

- In the **MAINTENANCE** menu, select the menu option **Rinse system**. The display shows **SYSTEM RINSES**

As soon as the rinse cycle is ended, the machine heats up and is then ready for operation again.

8.4. Clean system

- Put a sufficiently large container (≥ 0.5 l) under the height-adjustable outlet
- Select and confirm the instruction with the *rotary dial* or
- In the **MAINTENANCE** menu, select the menu option **Clean system**
- Follow the instructions in the display up to the end of the program and confirm each time with the *rotary dial* / by touching

The machine then heats up and is ready for operation again.

**NOTE**

A message / instruction is shown on the display when the machine has to be cleaned. Beverages can still be drawn. But we recommend carrying out the cleaning program as soon as possible to avoid endangering the warranty.

8.5. Descale system

CAUTION

The running descaling program must not be interrupted!

Never use vinegar or vinegar-based material for descaling, but always use **liquid products** recommended for fully automatic coffee machines (recommendation: NIVONA PREMIUM liquid descaler).

The filter (if present) must be removed from the water tank prior to the start of the descaling program.

During descaling, please follow exactly the sequence of the displays!

First pour in the corresponding amount of **water** up to the 0.5 l mark and **then** add **the descaler**.

Never in reverse order! Observe the instructions of the descaler manufacturer.

- Select and confirm the instruction with the *rotary dial* or
- In the **MAINTENANCE** menu, select the menu option **Descale system**
- Put a sufficiently large container (≥ 0.5 l) under the height-adjustable outlet
- Follow the instructions in the display up to the end of the program and confirm each time with the *rotary dial* / by touching

The machine then heats up and is ready for operation again.

CAUTION

Please always remove residual descaling fluid on the housing with a moist cloth afterwards!



Descal system



SCAN ME!

NOTE

A message / instruction is shown on the display when the machine has to be descaled. (The descaling program can also be started manually at any time.) Beverages can still be drawn. But we recommend carrying out the cleaning program as soon as possible to avoid endangering the warranty.

**CAUTION**

Clean the brewing unit at least once a month. Otherwise, warranty claims may be excluded.



Open/close
service door



Unlock
brewing unit

**CAUTION**

Never immerse the machine in water!

Do not use scouring agents for cleaning.

Dried milk residue is hard to remove. Therefore, always clean immediately after the machine cools down! Always follow the message / instructions in the display on rinsing and cleaning the frother.

8.6. Remove & clean brewing unit

The brewing unit should be removed and cleaned under running water as needed. Please never use detergent for this, only pure, **cold** water!

- Open the service door on the right side of the housing (gently pull the unlocking device inside the handle upward, then carefully remove the service door from the housing)
- Unlock brewing unit (press red switch upwards and turn the handle to the left up to the stop and to lock)
- Carefully remove the brewing unit with the handle
- Clean brewing unit under cold, running water and **then let it dry**
- Carefully insert brewing unit again and lock it (hold down red switch and turn the handle to the right up to the stop and to lock it)
- Close service door again (guide pins on the bottom of the service door into the recesses, then press the service door until it locks in place)

8.7. Clean regularly by hand

**NOTE**

Please follow these cleaning instructions. Maximum cleanliness is required, especially when handling food and beverages.

When cleaning the drip pan, make sure that the two metal contacts and the space between them at the rear of the drip pan are always clean and dry. Occasionally use some soapy water to clean the drip pan.

The machine is equipped with rear rollers. These permit movement on a flat work surface. This allows cleaning under the machine.

- Clean the housing inside and outside only with a soft, moist cloth without detergent
- Empty the drip pan and coffee grounds container not later than when shown in the display (only with the machine switched on, as only then can it tell that the containers have been emptied)
- After the drip pan and coffee grounds container have been removed, clean the housing inside with a soft, moist cloth without detergent
- The water tank should be rinsed with clean water daily and refilled with fresh, cool water
- Clean the frother, tube and outlet regularly

8.8. Disassemble and clean frother

- Remove the cover plate at the height-adjustable outlet, gently pull the frother down and then out to the front and take it apart
- Thoroughly clean the parts and put the frother back together
- Insert the assembled frother back in the height-adjustable outlet
- Reattach the cover plate to the height-adjustable outlet

NOTE

From time to time (ideally before every longer break in coffee making, but always on a regular basis!), the frother must be disassembled completely and then cleaned under clean water.



TIP

To clean the display during operation, the display can be locked in the **MAINTENANCE** menu under **Display Lock**. Pressing the *rotary dial* once releases the lock.



Cover plate on the height-adjustable outlet



Assembled frother



Individual parts of the frother

NOTE

You can continue to draw beverages. But we recommend changing the filter immediately.

CAUTION

Insert the filter **straight** and do not overturn



Filter

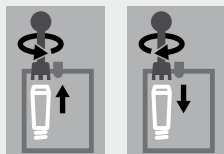

Unscrew / screw in the filter (in the water tank)

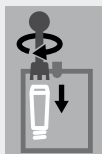
**CAUTION**

In case of low water consumption, you must replace the filter not later than after two months. No message appears in the display. You can set the replacement date with the dial on the head of the filter (month indicator).



Status of Maintenance

8.9. Change filter

The filter's effectiveness is used up after about 50 l of water has flowed through it. A message / instruction to replace the filter appears in the display.

- In the **SETTINGS** menu, select the **Filter** menu option
- Select **Yes** so that the machine detects that a filter is currently inserted
- Select **Change filter**
- Empty the water tank; carefully unscrew the old filter from its holder using the mounting aid at the end of the measuring spoon, and throw the filter away
- Carefully screw the new filter into its intended holder in the water tank using the mounting aid at the end of the measuring spoon
- Follow the instructions in the display up to the end of the program and confirm each time with the *rotary dial* / by touching
- Wait for some time until no more water comes out of the outlet

The machine then heats up and is ready for operation again.

8.10. Status of Maintenance

The machine shows through a progress bar whether cleaning or descaling will be required soon. The further to the right the progress bar is, the sooner the cleaning / descaling will be needed

- In the **MAINTENANCE** menu, select the **Status of Maintenance** menu option

9. SOLVING PROBLEMS YOURSELF

The following table shows some causes and options for solving the problem if the machine does not work properly.

If the system detects a fault, an error message appears in the display:

- **Note error message**
(According to the table on page 26 / 27, error 8 can sometimes resolve itself)
- **Switch off machine**
- **Pull out mains plug**



CAUTION

If an error occurs or a problem cannot be solved by yourself, please contact your specialist retailer or visit the service area at www.nivona.com.

The following information is important for fast, competent processing of the matter

- **Model** of the NIVONA product
- **Serial number**
- If available:
Error number / Error message

Type plate (example)

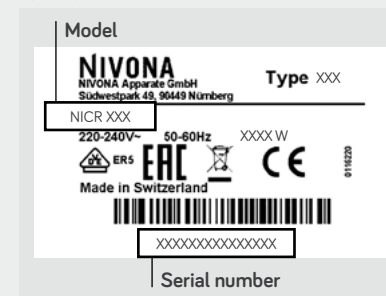

i NOTE

To avoid problems, the following should be observed:

- Always remove the water tank from the machine to fill it
- Do not store coffee beans in the refrigerator
- Always empty containers with the machine switched on
- Use fresh and cooled milk

Problem	Cause	Remedy
No hot water or drawing of milk foam / steam possible	System might need descaling	Perform high-dosage descaling (Chapter 8.5.)
	Frother is plugged	Disassemble frother completely and clean it thoroughly
Too little milk foam or liquid froth	Frother is plugged	Disassemble frother completely and clean it thoroughly
	Unsuitable milk	Use cold milk
	System might need descaling	Perform high-dosage descaling (Chapter 8.5.)
Coffee comes out only dropwise	System might need descaling	Perform high-dosage descaling (Chapter 8.5.)
	Grind fineness is too fine / too coarse	Set grind fineness coarser / finer (Chapter 7.2.)
	Ground coffee is too fine	Use coarser ground coffee
	Too much ground coffee added	Add less ground coffee
	Brewing unit is plugged	Remove and clean brewing unit (Chapter 8.6). Reinsert brewing unit and perform a system cleaning (Chapter 8.4.)
	Coffee outlets are plugged	Perform system cleaning (Chapter 8.4.)

Problem	Cause	Remedy
Coffee does not have "foam"	Brewing unit is plugged	Remove and clean brewing unit (Chapter 8.6). Replace brewing unit and perform a system cleaning (Chapter 8.4).
	Unsuitable coffee type	Change coffee type
	Beans are no longer roast-fresh	Use fresh beans
Loud noise in the coffee grinder	Grind fineness not adapted to coffee beans	Optimise grind fineness (Chapter 7.2.)
	Foreign matter in the grinder, e.g. small stones	Call NIVONA service telephone; ground coffee can still be used
The display shows Error 8 Service Tel	The drive cannot properly position the brewing unit	Switch off the machine and pull out the plug. Plug it back in and switch on the machine. If the machine is ready for operation, remove and clean the brewing unit (Chapter 8.6).
Despite emptied and inserted containers, the display shows Empty trays	Gap between the contacts at the rear end of the drip pan is dirty	Clean gap between the contacts with water and some detergent as well as a brush, then dry

DE

GB

FR

NL

PL

RU



Evaporate
system



SCAN ME!



CAUTION

The running program must not be interrupted!



WARRANTY AND CUSTOMER SERVICE CONDITIONS

Please see the accompanying information sheet for detailed warranty and customer service conditions.

10.

10. ACCESSORIES & COFFEE ASSORTMENT

Our current assortment of accessories and coffee can be found at www.nivona.com.

11.

11. CUSTOMER SERVICE & WARRANTY

If you have to send in the machine due to a defect, first evaporate it out so that no water remains in the system.

How to make your machine ready for shipment | Evaporate machine

- In the **MAINTENANCE** menu, select the **Evaporate system** menu option
- Follow the instructions in the display up to the end of the program and confirm each time with the *rotary dial* / by touching
- Empty drip pan, coffee grounds container, water tank and the coffee bean holder as well as possible
- Reinsert all parts
- Pack the machine, ideally in the original packaging (no liability can be accepted for transportation damage)

12.

12. PACKAGING & DISPOSAL

The machine's complete original packaging should be kept to protect it during shipping in case customer service is needed.

Electrical and electronic appliances contain many materials which are still valuable or are harmful to the environment, and these should not be treated in the same way as normal

household waste. If treated as household waste or handled incorrectly, they may cause harm to human health or the environment. Therefore, never throw a defective machine away with household waste, but bring it to the community collection point for return and recycling of old electrical and electronic devices

You can obtain more information from your local town hall, waste disposal service provider, or the retailer from whom the machine was purchased.
Filter cartridges are disposed of as household waste.

13. TECHNICAL DATA

Voltage	220–240 V AC, 50-60 Hz
Power output	1465 W
Conformity mark	CE
Static pump pressure max.	15 bar
Water tank capacity	approx. 2.2 l
Coffee bean holder capacity	approx. 270 g
Coffee grounds container capacity	approx. 10-15 portions*
Cable length	approx. 1.1 m
Weight	approx. 11.4 kg
Dimensions (W x H x D):	approx. 28 x 36 x 50 cm
Bluetooth**	Frequency range: 2,400 MHz - 2,483.5 MHz Max. transmission output: 10 mW

Detailed information on energy consumption can be found via the following QR code:



* Depending on the coffee strength used

** NIVONA Apparate GmbH hereby declares that the radio equipment complies with the Directive 2014/53/EU.
The complete text of the EU conformity declaration is available at the internet address www.nivona.com in the SERVICE download area.



NIVONA

*passion
for coffee*



NIVONA Apparate GmbH

Südwestpark 49
D-90449 Nürnberg, Germany
www.nivona.com

2025 © Copyright NIVONA Apparate GmbH, Germany
All rights reserved

ANR 000129137
BDA NICR 960 – 970 GB Rev.02 29.04.2025